

D. REVIS.		BANDALUX	
REVISION	1 2 3 4 5 6 7 8 9		
DATE	14-12-2017	PLANE N°	
DESIGN	Miquel P.	FORMAT	A-3
SCALE	Rolling blind in Box B-Box 5" chain U-401 guided Aluminum side channel guided lateral installation Mechanism: VTX30 Bottom rail: round hembar 3/4" (Ø20mm) Tube 2 9/16" (Ø65mm)		
1/1			

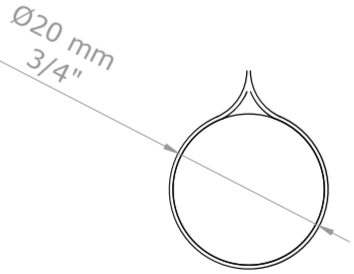

Detail 1:1 round hembar
3/4" (Ø20mm)

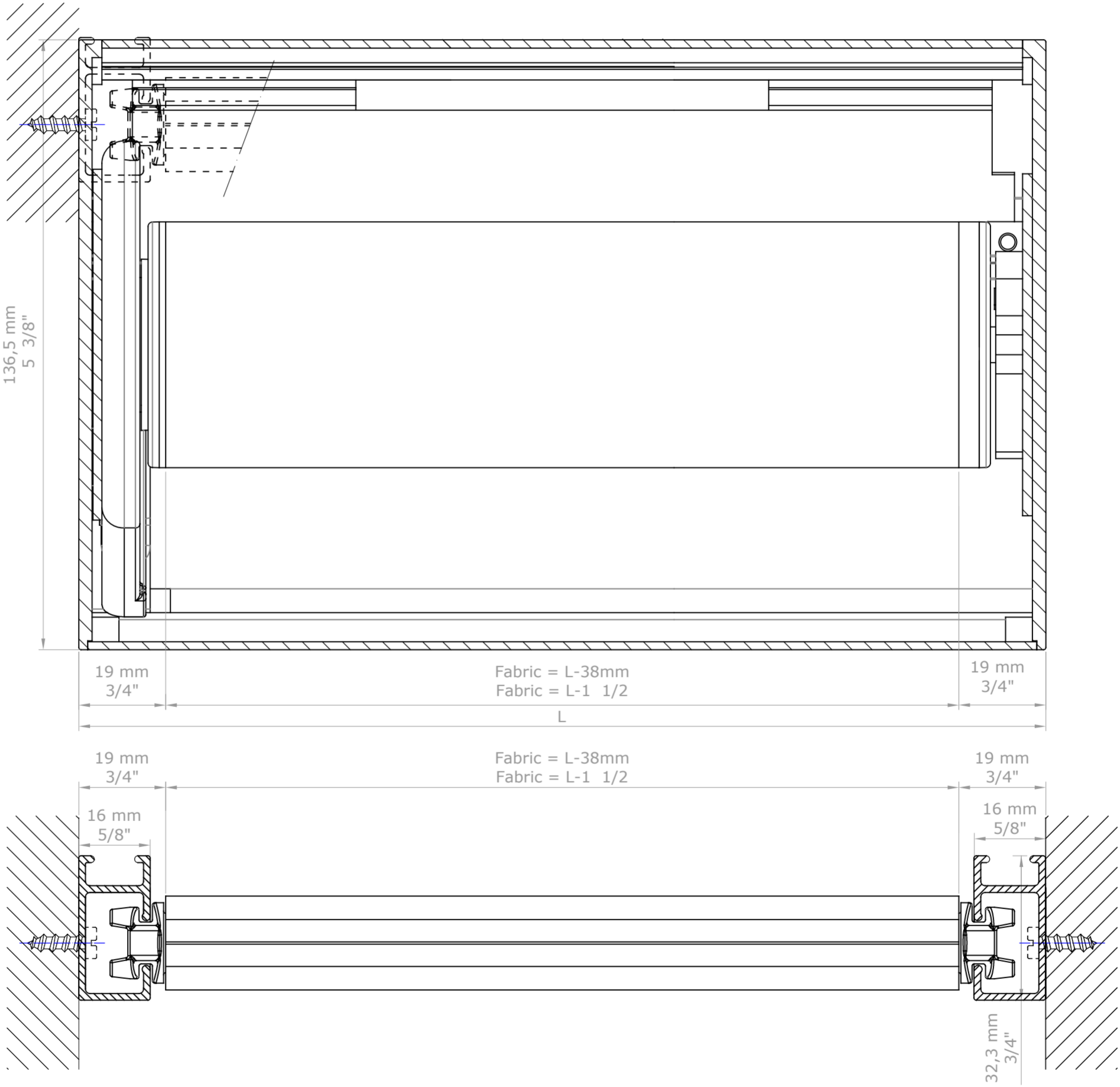
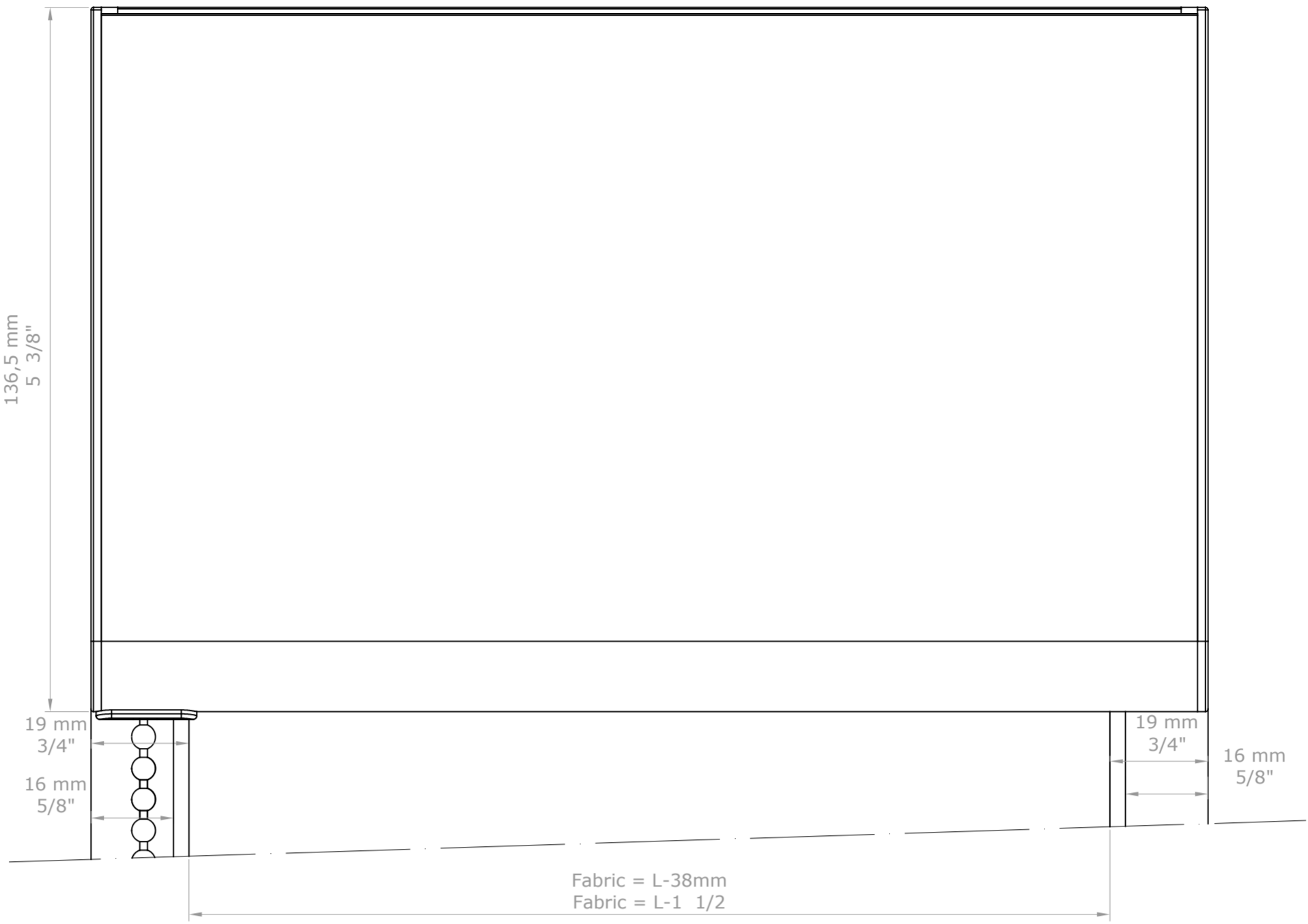
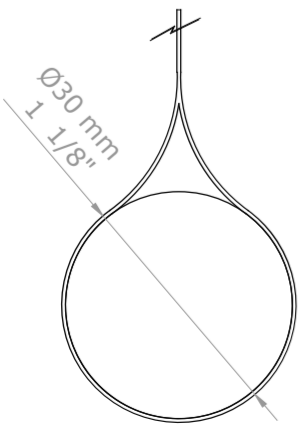

Detail 1:1 round hembar
1 1/8" (Ø30mm)

D. REVIS.	BANDALUX		
REVISION	1	2	3
DATE	14-12-2017	PLANE N°	
DESIGN	Miquel P.	FORMAT	A-2
SCALE	Rolling blind in Box B-Box 5" chain U-401 guided Aluminum side channel guided lateral installation Mechanism: VTX30 Bottom rail: round hembar 3/4" (Ø20mm) Tube 2 9/16" (Ø65mm)		
1/1			

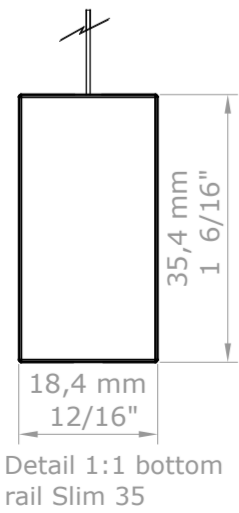
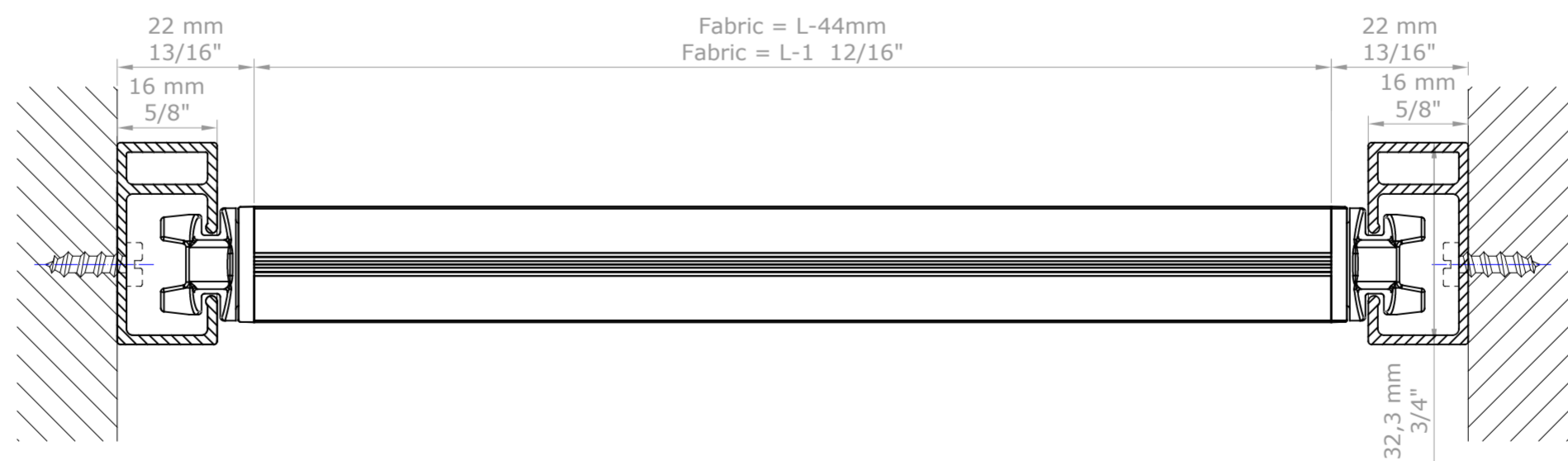
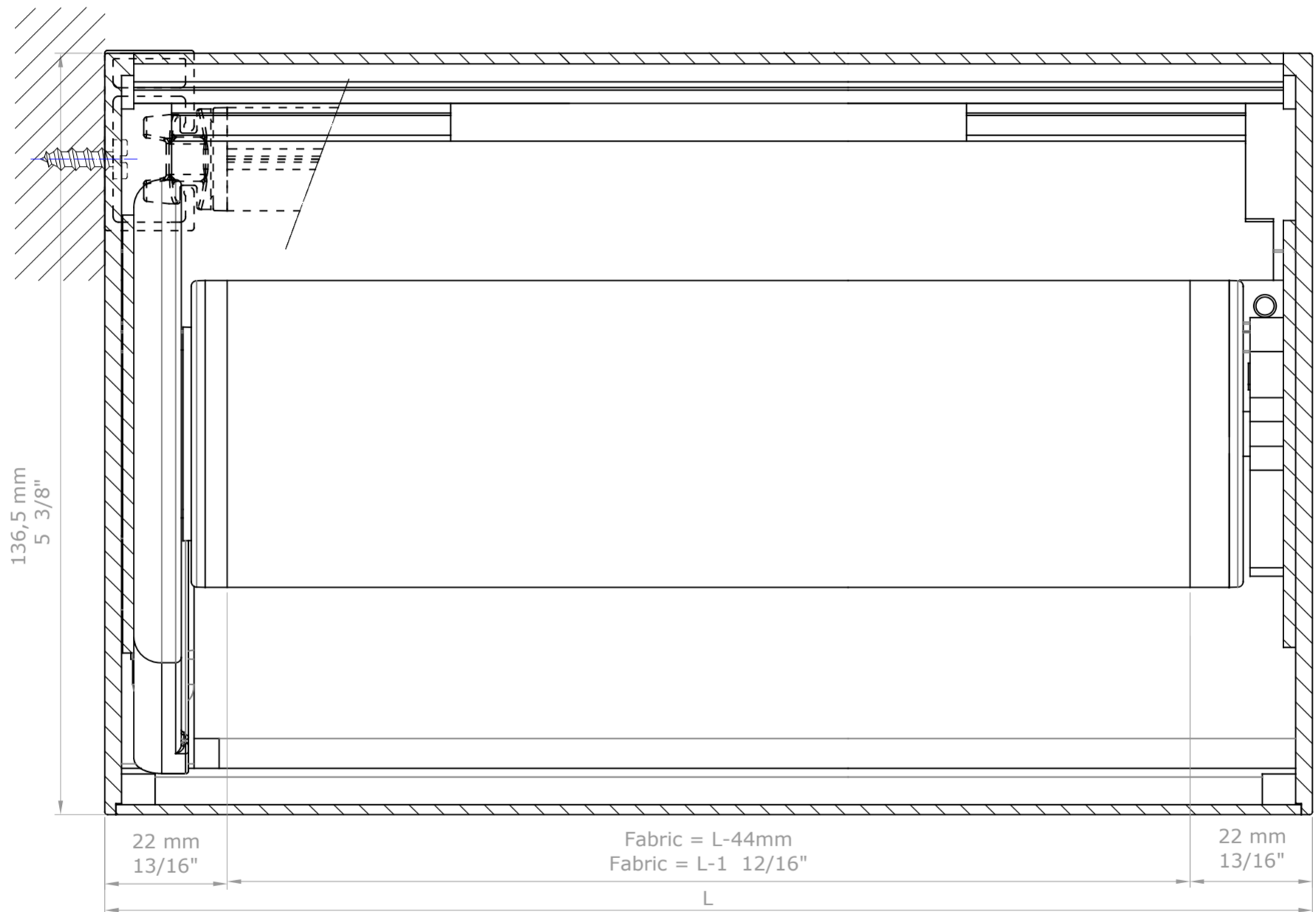
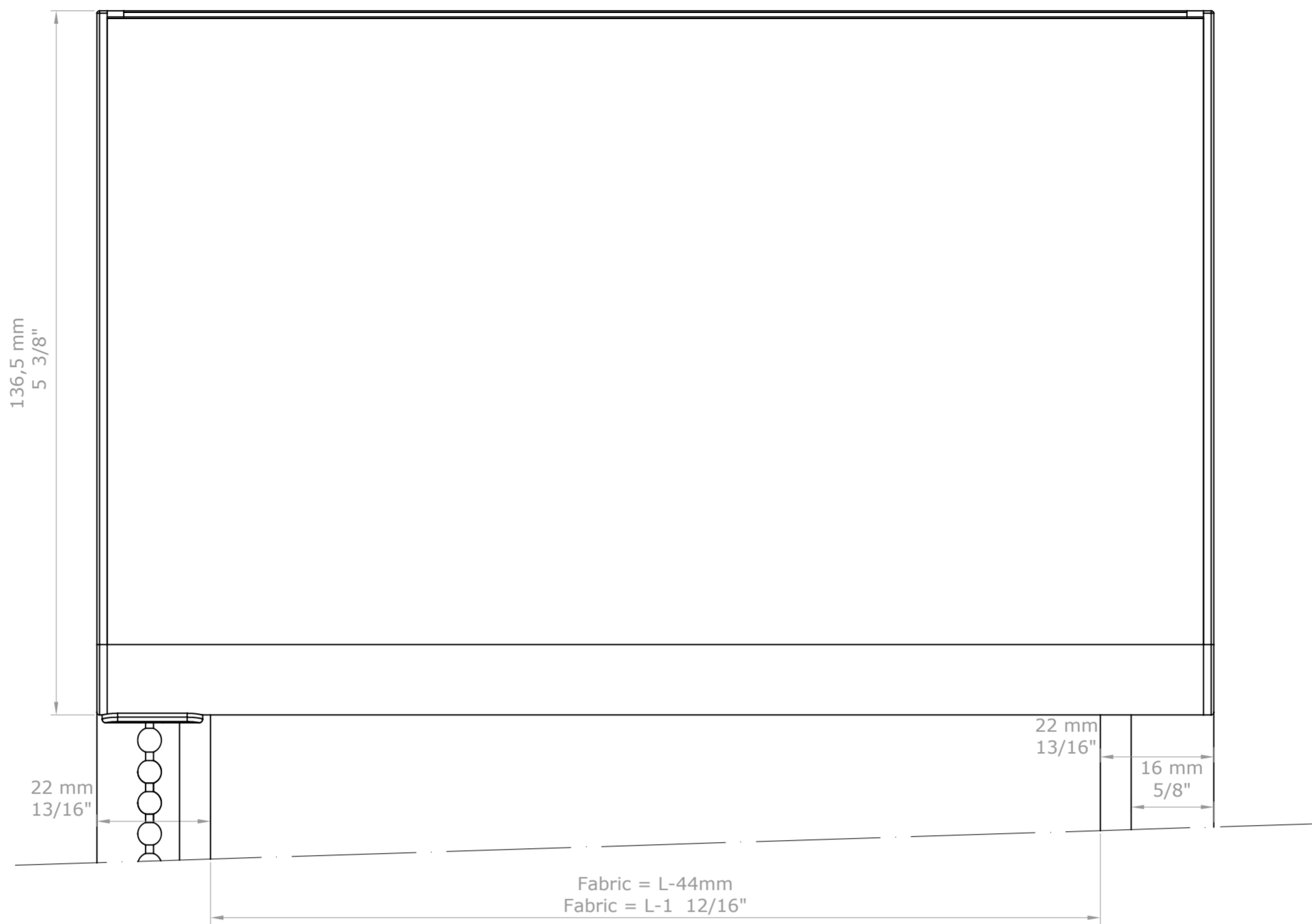

D. REVIS.	BANDALUX		
REVISION			
DATE	14-12-2017	PLANE N°	
DESIGN	Miquel P.	FORMAT	A-2
SCALE	Rolling blind in Box B-Box 5" chain U-401 guided Aluminum side channel guided lateral installation Mechanism: VTX30 Bottom rail: Slim 35 Tube 2 9/16" (Ø65mm)		
1/1			

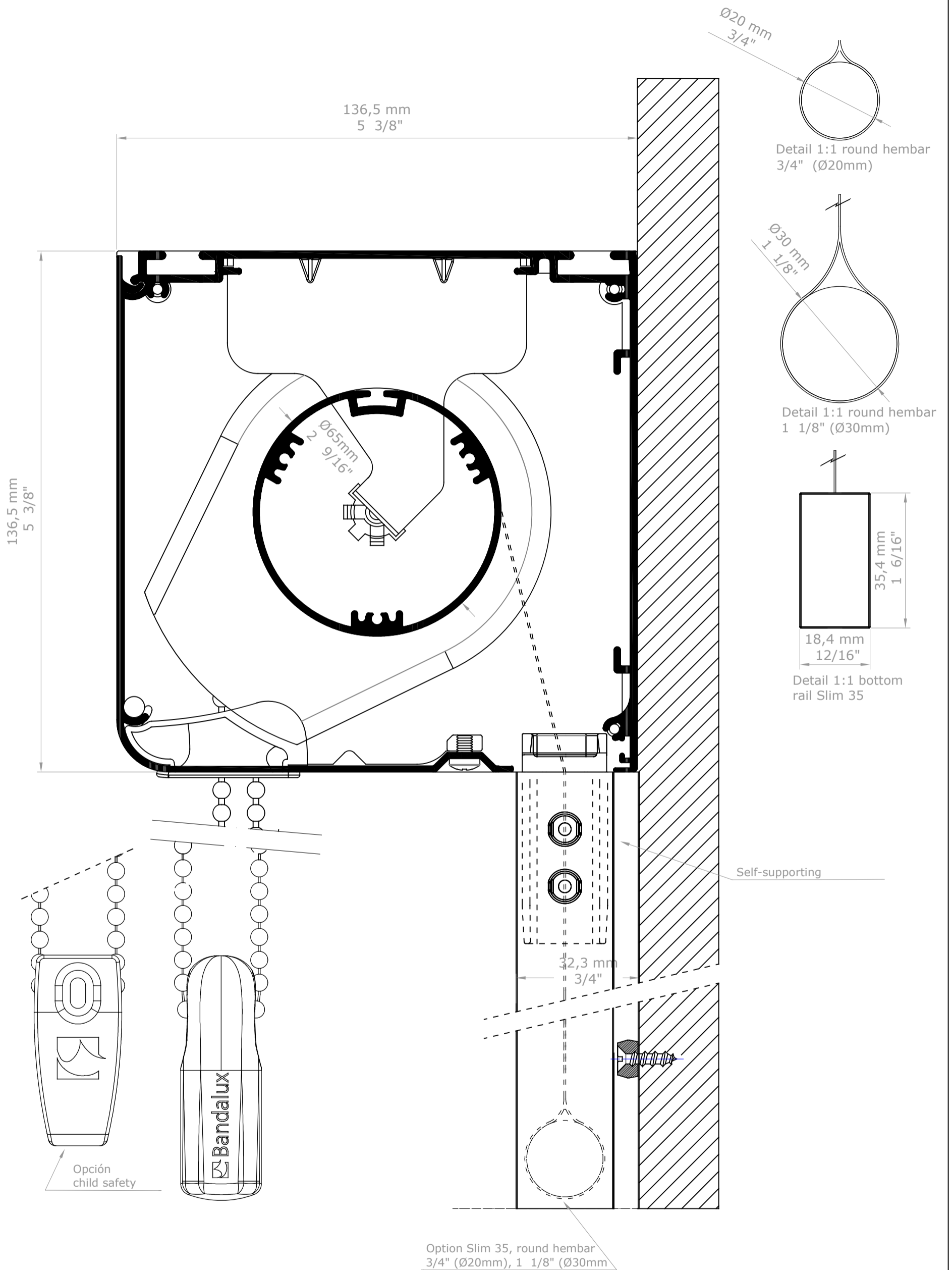

D. REVIS.		BANDALUX	
REVISION	123456789		
DATE	15-12-2017	PLANE N°	
DESIGN	Miquel P.	FORMAT	A-3
SCALE	Rolling blind in Box B-Box 5" chain U-401 guided Aluminum side channel guided front installation Mechanism: VTX30 Bottom rail: round hembar 3/4" (Ø20mm) Tube 2 9/16" (Ø65mm)		
1/1			

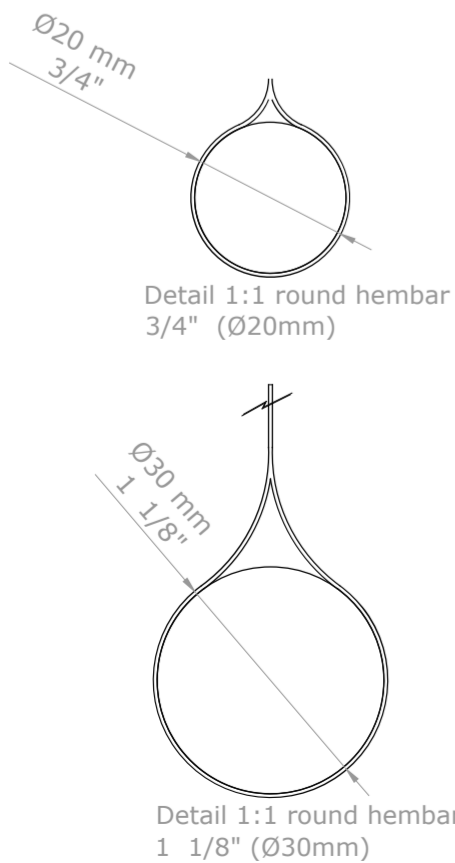
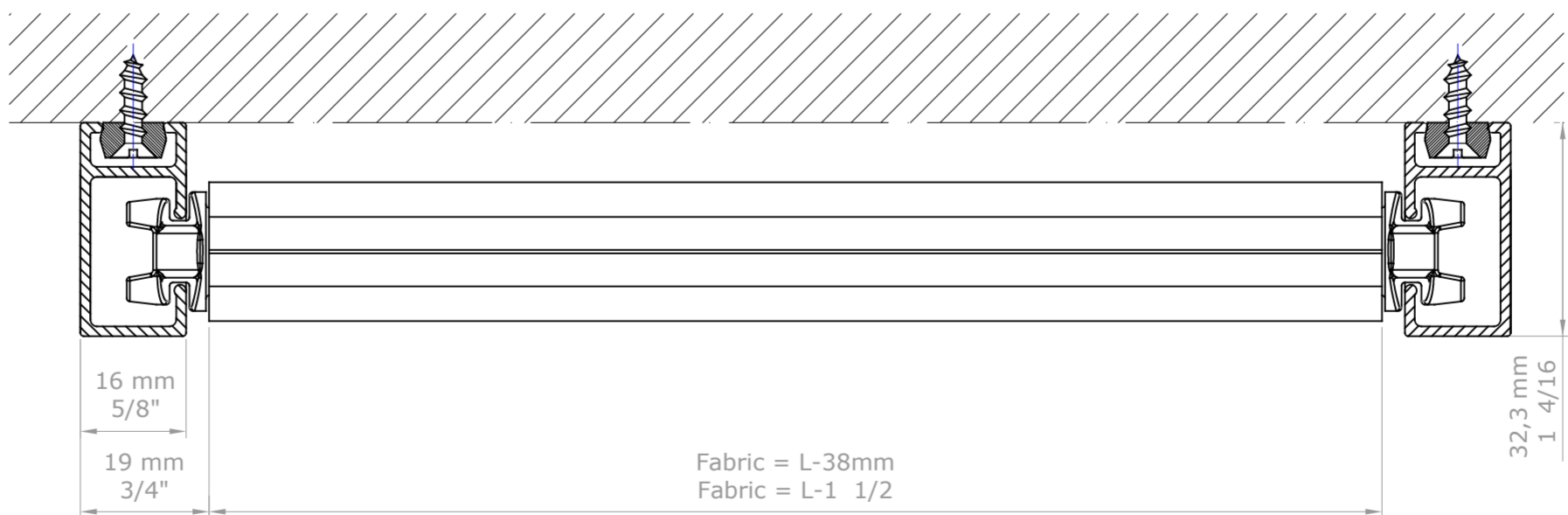
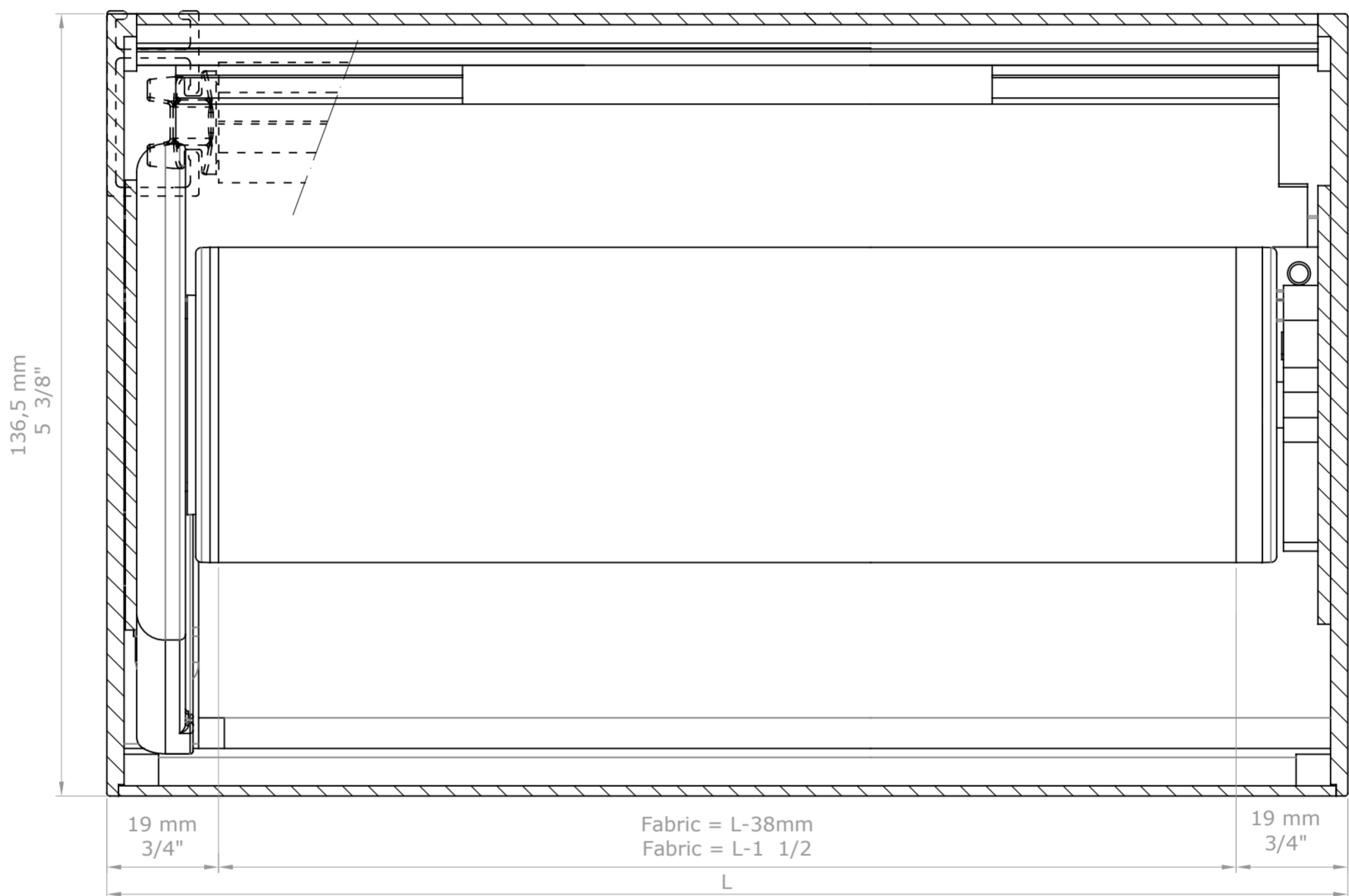
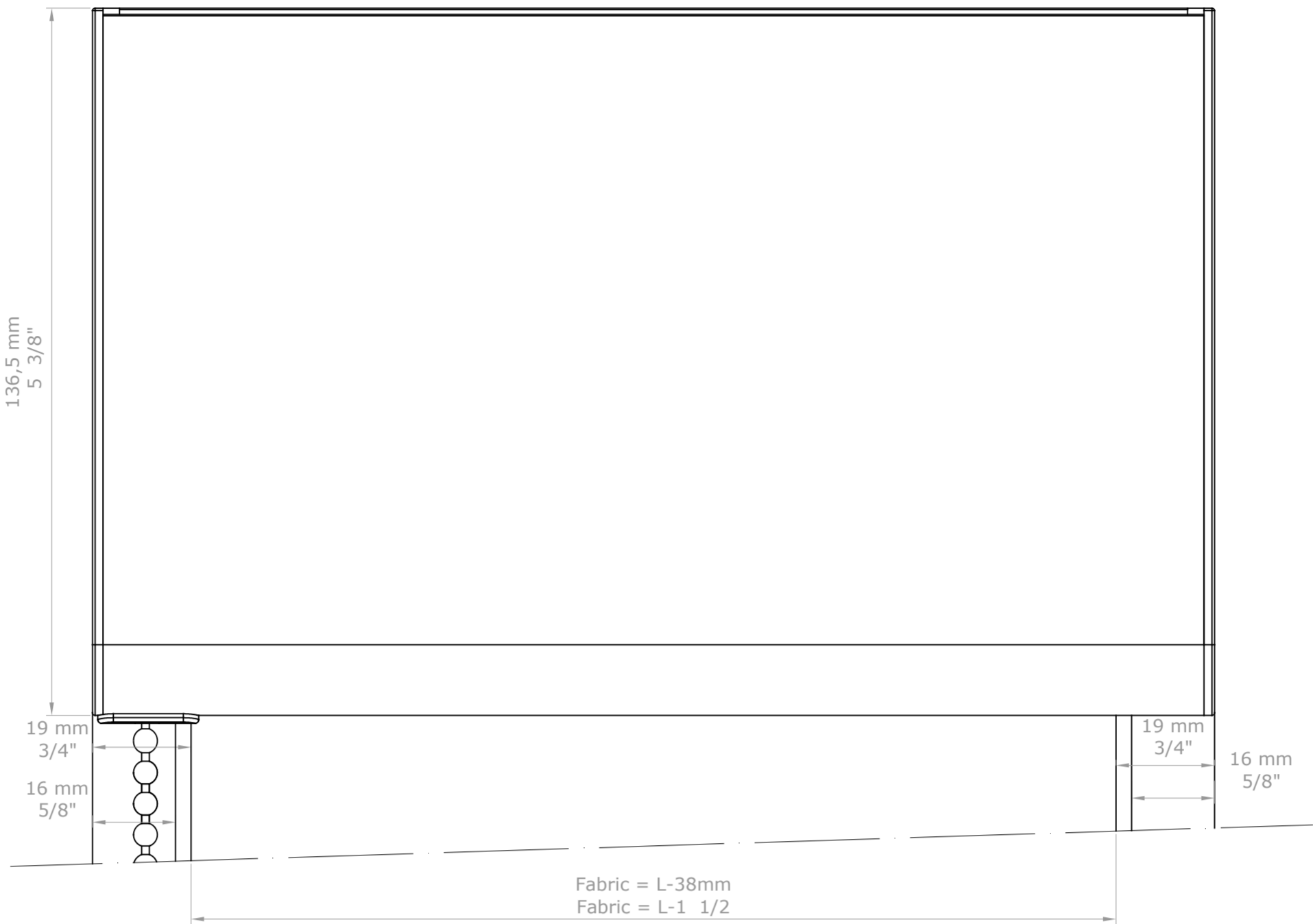

D. REVIS.					BANDALUX	
REVISION	1	2	3	4		
DATE	15-12-2017				PLANE Nº	
DESIGN	Miquel P.				FORMAT	A-2
SCALE	Rolling blind in Box B-Box 5" chain U-401 guided Aluminum side channel guided front installation Mechanism: VTX30 Bottom rail: round hembar 3/4" (Ø20mm) Tube 2 9/16" (Ø65mm)					
1/1						

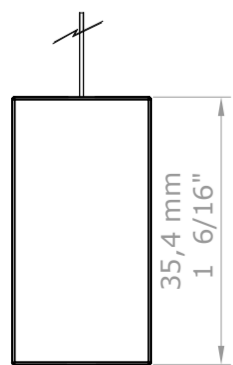
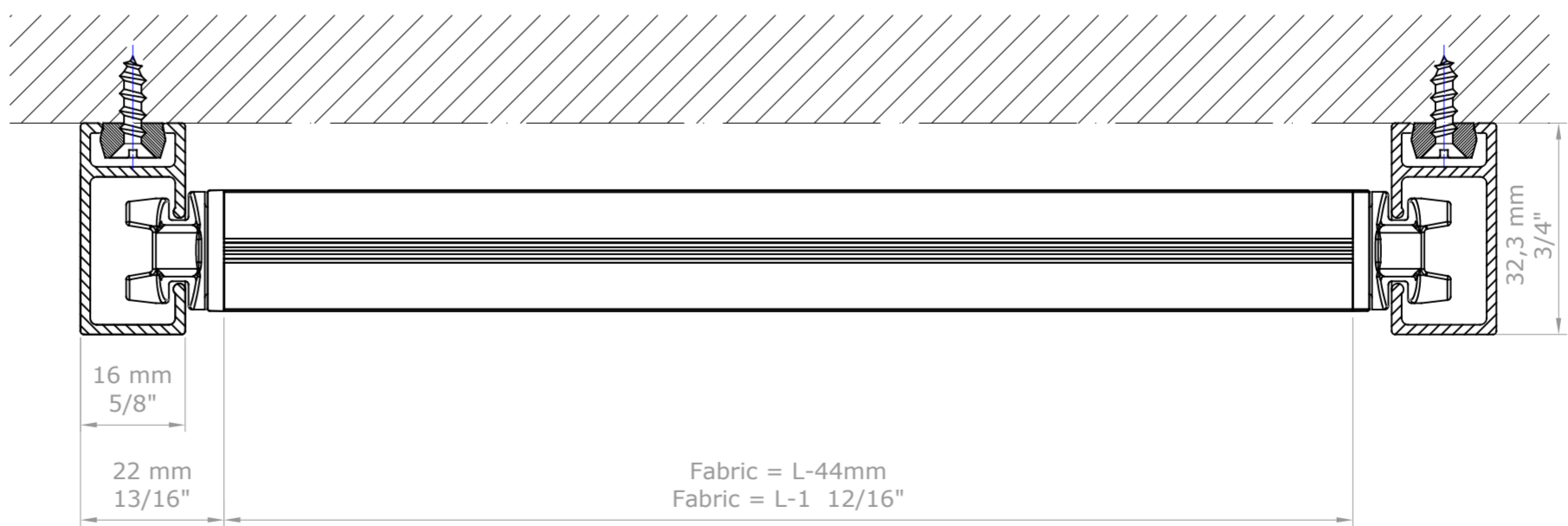
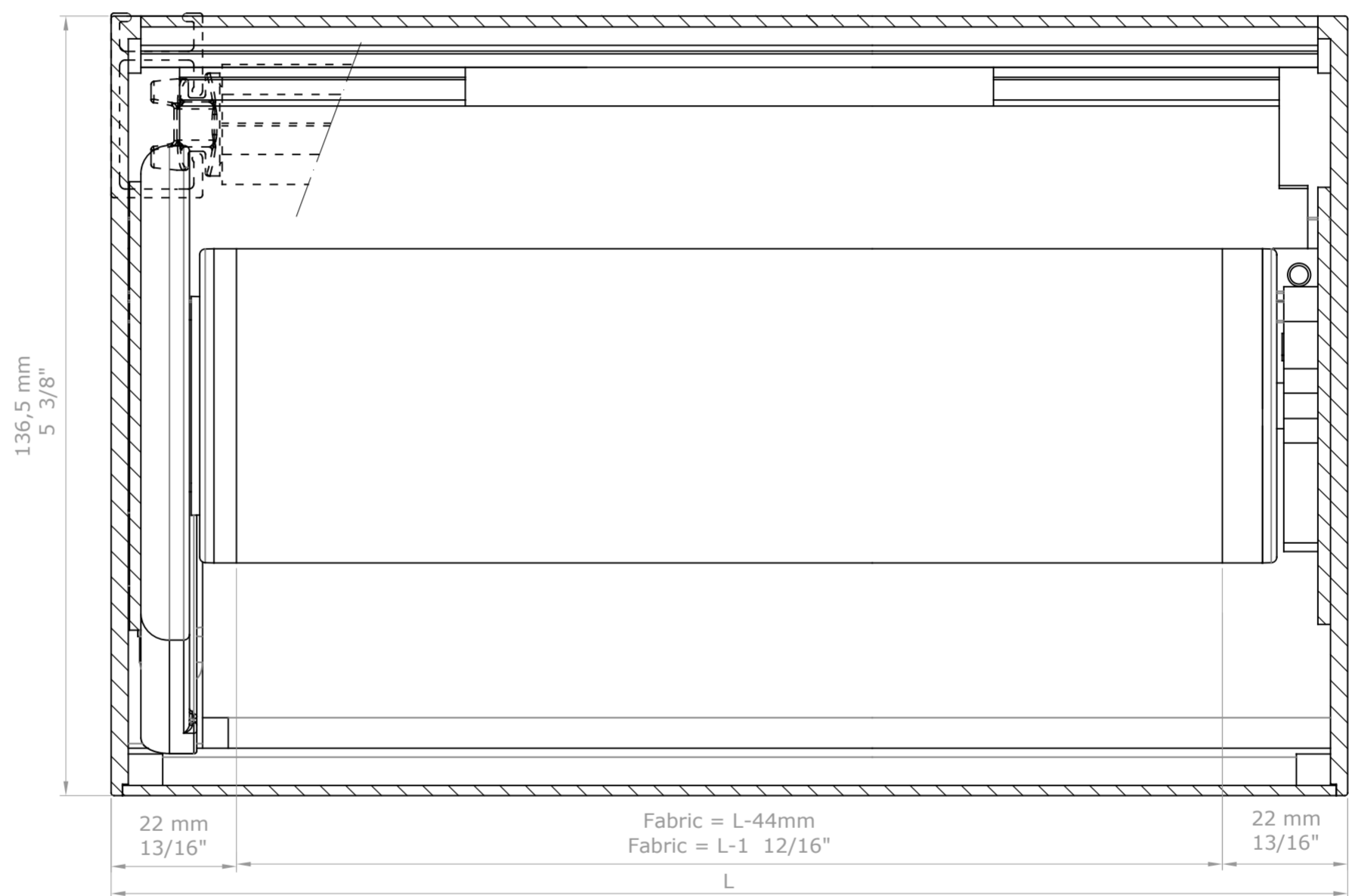
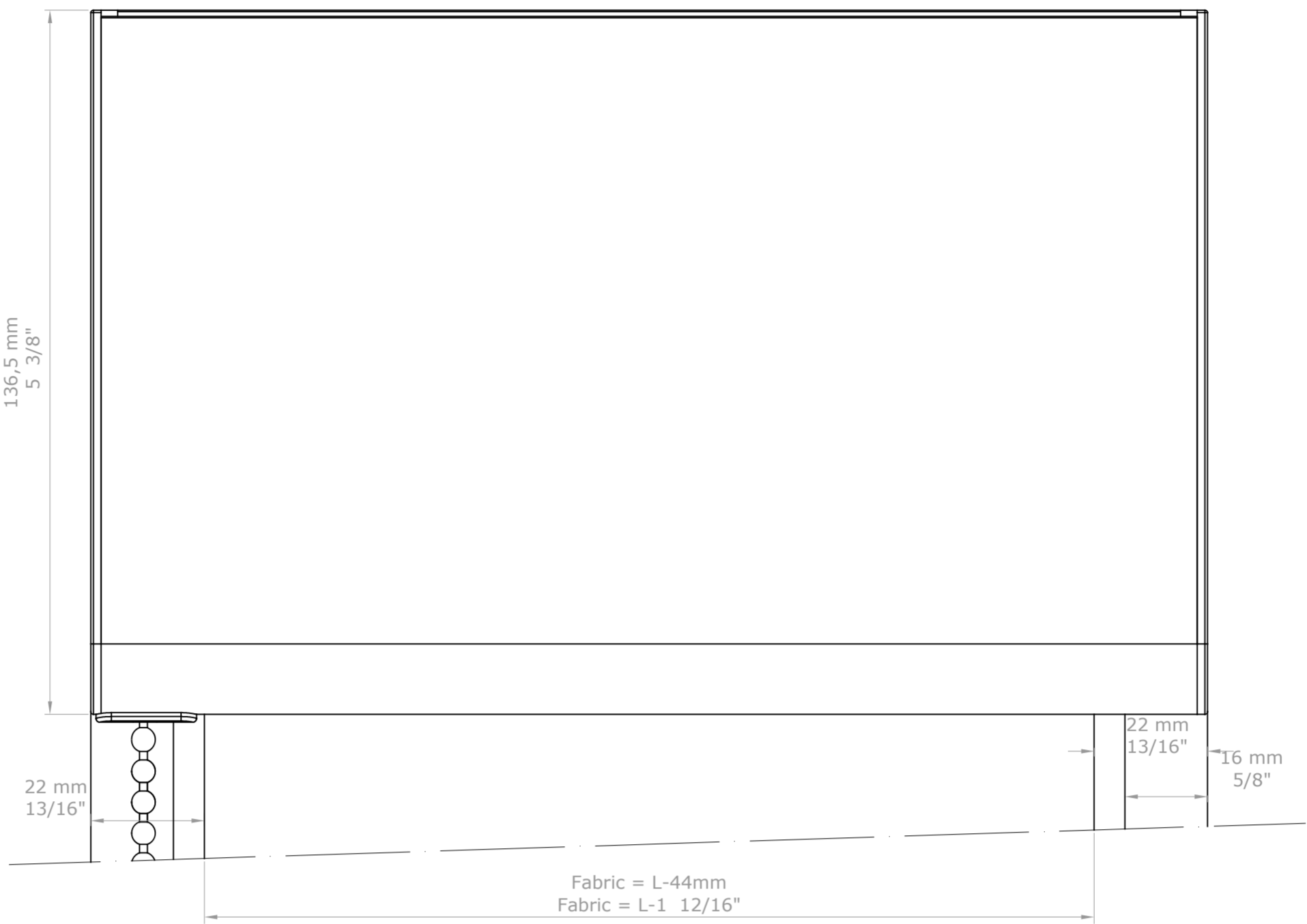

Detail 1:1 bottom rail Slim 35

D. REVIS.	BANDALUX		
REVISION			
DATE	15-12-2017	PLANE N°	
DESIGN	Miquel P.	FORMAT	A-2
SCALE	Rolling blind in Box B-Box 5" chain U-401 guided Aluminum side channel guided front installation Mechanism: VTX30 Bottom rail: Slim 35 Tube 2 9/16" (Ø65mm)		
1/1			